

# LUMINO

## V36P

### INSTALLATION MANUAL

IMV36P\_R2201

### TECHNICAL SUPPORT

+44(0) 1279 635 411  
www.lumino.lighting

### LUMINO DISTRIBUTION LTD

Lumino House, Lovet Road  
Harlow, Essex CM19 5TB  
United Kingdom

Authorised EU Representative:  
LDL LIGHTING EUROPE LIMITED  
The Black Church, St Mary's Place  
Dublin, D07 P4AX  
Ireland

Installers must read this document and any other referenced documents in full before commencing installation work. Failure to observe all installation guidance in this document may result in unsafe installation, cause permanent product damage and void product warranty.

This document is subject to change without notice. Check for latest documentation with LUMINO. Copyright © LUMINO. E&OE



### HANDLING PRECAUTIONS

#### PLASTIC COVER / DIFFUSER

To avoid permanent damage, do not allow small or sharp objects to apply pressure on to the plastic cover / diffuser.

#### STRESS

Never stand or place weighted items on the product. The product is not vandal resistant and has no IK rating. Do not subject the product to impact forces.

#### SUSPENDING THE PRODUCT

Ensure that mounting surface is capable of supporting at least 5 times the weight of the product. Take appropriate precautions when suspending the product. Support the product on both ends. Do not allow the product to hang on one side. Stable, level, horizontal mounting only.

#### POWER CABLES

The product end caps, power cables and connectors must not be pulled or twisted. Never pull or hang the product by its power cables or connectors.

#### CUTTING, SAWING, MODIFICATION

The product must not be sawn, drilled or otherwise modified in any way.

#### DAMAGES

Inspect the product. If you see any damage upon unpacking, report to LUMINO immediately and do not install the product.

#### LOCATION

**Suitable in dry locations only. IP20 rated for protection against objects 12.5mm or larger.**

Protect product from dust, paint and harmful substances during installation and use. Ensure product is not exposed to VOC gases. Do not install product within reach of children or animals. Do not swing or attach items to product. Unsuitable for environments subject to airflow.

### SAFETY GUIDANCE AND CARE

#### WIRING GUIDE

Follow the guidance shown in the provided wiring guide, including maximum cable lengths, cable sizes and other wiring instructions. When running cables through an enclosure, ensure cables are protected from damage, separated from mains voltage cables and anchored against being pulled. Make connections appropriate for the IP rating of the product.

#### QUALIFIED INSTALLER

Installation must be carried out by a qualified person and conducted in accordance with local regulations and applicable standards.

#### CLEANING

Clean the product with a dry cloth. Do not use harsh cleaning chemicals.

#### THERMAL MANAGEMENT

Ensure ambient temperature ( $T_a$ ) does not exceed  $40^{\circ}\text{C}$  ( $104^{\circ}\text{F}$ ) and case temperature ( $T_c$ ) does not exceed  $70^{\circ}\text{C}$  ( $158^{\circ}\text{F}$ ). Exceeding maximum  $T_c$  will cause permanent damage and void the product warranty. Allow sufficient clear air space for the LED drivers, as well as suitable access to the drivers as specified on installation instructions.

#### REPAIR AND REPLACEMENT

If the product is not functioning, contact LUMINO to register a Service Call for factory repair or replacement. Product's light source is replaceable by a qualified professional. See page 5 for Ecodesign and end of life information.

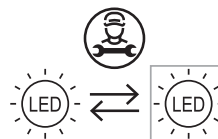

### DRIVERS

#### POWER OFF

Product and driver must not be live wired. Switch off power before work begins. Follow instructions and guidance for the make and model of driver being used.

#### 24VDC SELV

Only use drivers with a maximum output of 24VDC. Drivers must be SELV, constant voltage with both overload and short-circuit protection.

#### DIMMERS

Check dimmer is compatible with the driver and certified to local regulations.

#### INRUSH CURRENT

Many constant voltage LED drivers can have high inrush current at power-on. Driver's inrush current can be many times the normal operating current. Use a suitable MCB. Type C MCBs are normally suitable but if inrush current is a persistent problem an inrush suppressor may be required.

#### PROTECTION

Use only with 24VDC Class 2 power unit to UL1310 standard with overload and short-circuit protection. Rate drivers for at least 10% above load. Driver protection circuitry must not be relied upon to protect secondary 24VDC electrical circuits from damage caused by over-current or short circuit. DC fuses or DC electronic circuit breakers are recommended for full protection. Allow for access to drivers for maintenance and sufficient clear air space for ventilation.

#### CABLING

Do not overload the driver. Damage will be caused by incorrect input voltage, reverse polarity or short circuit. Plan for loads, driver locations, dimming and cabling prior to start of work. Ensure basic insulation is maintained between mains and dimming control wires.

## ACCESSORIES

### IDC Connector

VECA-CA90\_\_\_-R1

Sealant connector.

1 - 3A Max / 3 - 5A Max. Pair



### Ceiling Plate

V36P-M\_\_\_300-R1

Ceiling plate with cable exit

D - Silver / F - Black / E - White

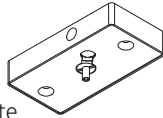

### Wire Mount

V36P-MA310-R1

Suspension wire to profile mount

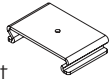

### Drop Wire

V36P-MA33\_\_\_-R1

Suspension wire with ceiling fixing

2 - 2m cable / 6 - 6m cable

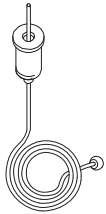

### Linear Joiner

V36P-MA320-R1

Joining bracket for V36P system

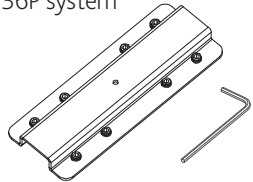

### End Cap Kit

V36S-M\_\_\_202-R1

Pair of end caps

S - Silver / B - Black / W - White

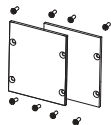

## CHECK FIRST!

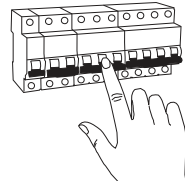

EN: TURN OFF POWER!  
FR: COUPER LE COURANT!  
DE: STROM ABSHALTEN!  
ES: CORTE CORRIENTE!

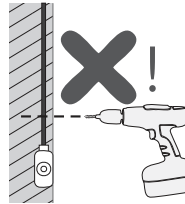

EN: CHECK THE SURFACE!  
FR: VÉRIFIER LA SURFACE!  
DE: DIE OBERFLÄCHE ÜBERPRÜFEN!  
ES: COMPROBAR LA SUPERFICIE!

## INSTALLATION

### 1. Plan Installation

Check product and its dimensions against the planned installation.  
Runs of LEDs may have to be installed in a particular sequence.

In-line types:

V = Single

W = Start

X = Middle

Y = End

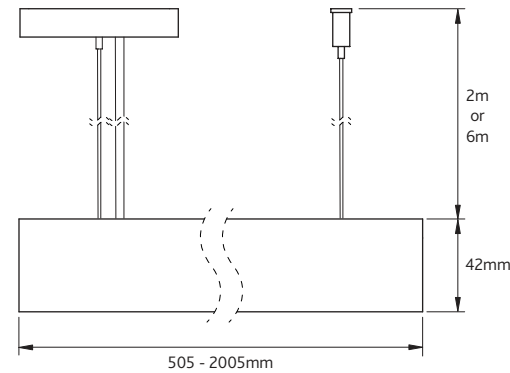
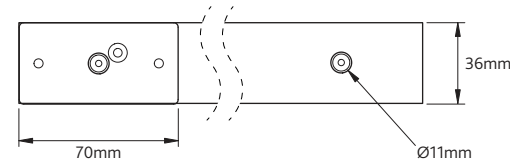

### 2. Prepare Power Supply

This product requires a 24VDC power supply. Please refer to provided wiring guide document. Failure to follow guide may result in damage to the product and voiding of warranty.

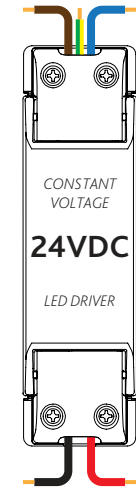

### 3. Mounting Surface

Plan cable entry/exit points before installing the product. Make suitably sized holes for fixings, cable and suspension wires to pass through. It is important that the fixings are capable of supporting at least 5 times the weight of the product.

**Do not install on a surface that is unstable or unfit to bear weight.**

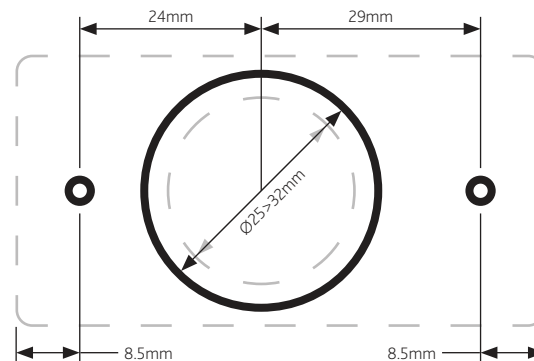

Ceiling Plate  
70mm x 36mm

### 4. Fixing Positions

For a clean looking appearance and to evenly distribute the weight of the product/s, plan fixing positions.

X = (All versions) Equal distance from drop wire to end cap.

Y = (For joined V36P) Equal distance.

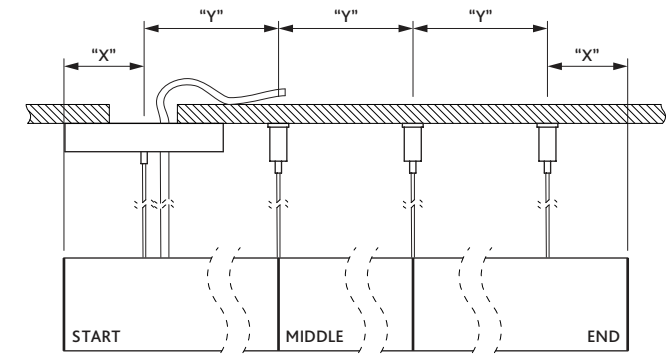

## 5. Power cable

Loosen nylon screw inside the ceiling plate, then feed the clear cable through the ceiling plate. Allow the cable to freely move until the V36P is at its final resting height.

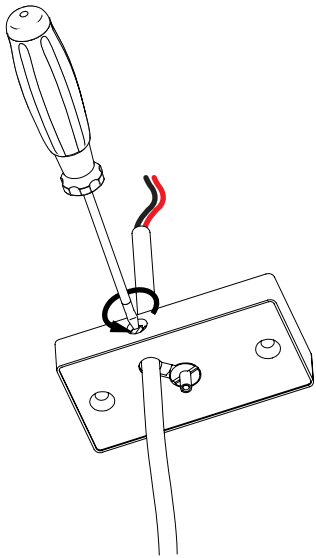

## 6. Cabling

Feed V36P power cable through to the driver location, or present the first fix power cable outside of the cable exit ready for connecting.

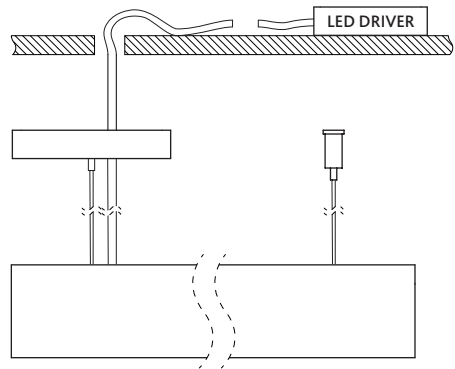

## 7. Power Connection

V36P is supplied with connecting leads (tails), requiring a terminal block to connect the product to the specified 24VDC LED driver.

Terminal block must conform to IEC 60998-2-1 or IEC 60998-2-2. The requirements of Clause 4.6, 4.7.1, 4.7.2, 4.10.1, Clause 11.2, Section 12 and Clause 13.2 shall apply.

Additionally, it must feature:

- Screw or screwless terminals.
- 2/3/4/5 terminals according to LED type.
- Rated voltage >450V.
- Cross-sectional capacity 0.5-2.5mm<sup>2</sup>.

Make all necessary preparations to the conductors, such as twisting stranded wires and fully inserting wires into terminals.

Finalise all electrical connections and test the circuit. If the product does not function as expected, turn power off immediately and check all connections before retesting.

Protect the terminal block within an appropriate enclosure that can be secured in place.

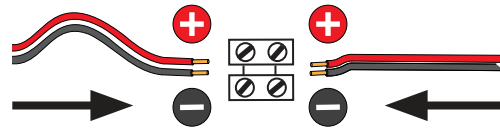

## 8. Ceiling Fixing

Unscrew the two pieces that make up the ceiling fixing.



LED	Wiring Diagram
ColorCORE® EQ	Common (+) (CH1-)
RGB	Common (+) Blue (CH3-) Green (CH2-) Red (CH1-)
WarmDIM	Common (+) (CH1-)
ColorTUNE	Common (+) Warm (CH1-) Cool (CH2-)
RGBW	Common (+) Blue (CH3-) Green (CH2-) Red (CH1-) Brown (CH4-)

## 9. Ceiling Fixings

Surface fixings should be suitable for Ø4mm screws. It is important to use appropriate fixings to mount the ceiling plate and ceiling fixing to the mounting surface.

Considerations should be made for the type of surface being fixed to and that the fixings should be capable to securely hold at least 5 times the weight of the product.

Example below shows rawplug/drywall anchor fixings for a plasterboard ceiling.

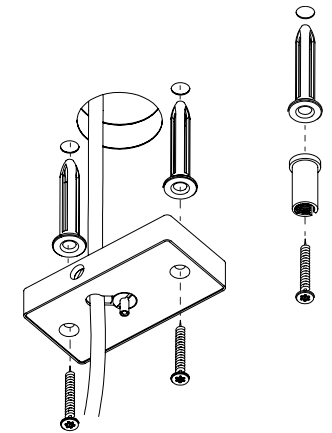

## 10. Fix Mountings to Ceiling

Fasten ceiling plate and ceiling fixing to the mounting surface. Screw fasteners should be Ø4mm countersunk head type, with a head diameter no greater than Ø6.8mm.

## 11. Feed Drop Wire into Ceiling Fixing

Feed a short length of the drop wire into the ceiling fixing. This will aid in installation and height adjustments.

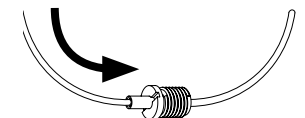

## IMPORTANT! Raising the V36P

Care and attention is required. Use appropriate PPE and equipment, such as stepladders or scissor lifts. V36P must be supported when raising into position. Two people maybe required to do this safely and to avoid the product from falling or swinging outwards.

## 12. Ceiling Fixing

Replace the other half of the ceiling fixing.

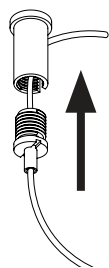

## 13. Drop Wire

Support the V36P on a stable surface, then feed the drop wire into the ceiling plate and ceiling fixing. Wire is held in place by a sprung grip inside. Install by pushing in the sprung collar. Release the sprung collar to hold the drop wire.

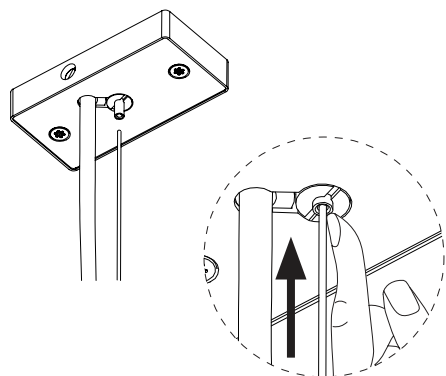

## 14. Adjust V36P Height

Suspend the product at a height as specified by the planned installation or at a level that is appropriate for the application, **well above head height**.

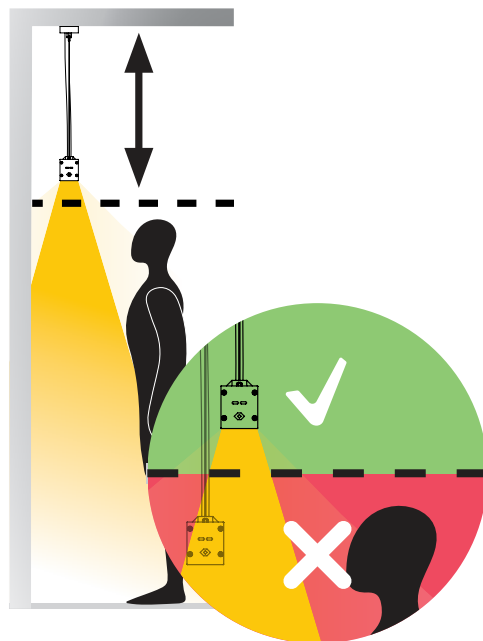

## 15. Secure Cable

Feed excess power cable through the ceiling plate, matching the length to the drop wire. Tighten nylon screw to secure cable.

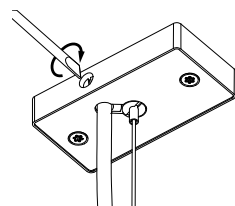

## 16. Trim Drop Wires

Trim off excess drop wire as necessary using wire/cable cutters. Take care when cutting stainless steel wire and use appropriate PPE.

## JOINED IN-LINE V36P

For V36P in-line types: W, X and Y.  
Installation closely matches the installation steps shown in the previous steps. The following guide shows the steps unique to the joined in-line V36P.

### 1. Plan Installation

Joined in-line products must be installed in the given sequence as shown. Follow the "start" to "end" sequence.

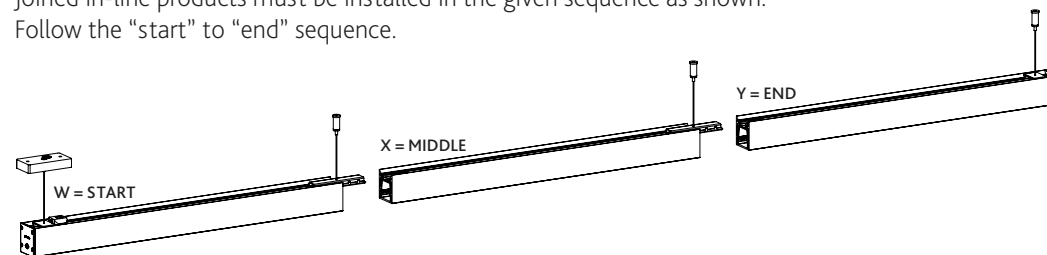

### 2. Power Connectors

With the power off, join power connectors between "start", "middle" and/or "end" products.

**Only connect one product length at a time!**

Two people maybe required to do this safely and to avoid the product from falling or swinging outwards. Loosen grub screws on the linear joiner and shift to one side for easier access.

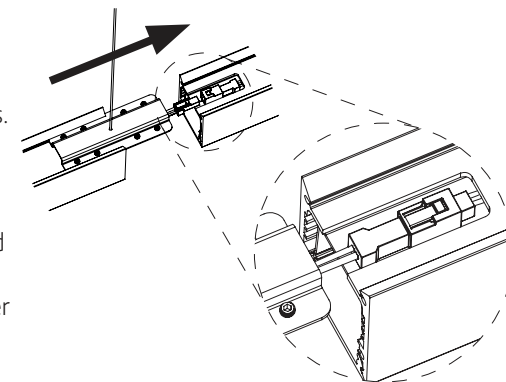

### 3. Join Products

Loosen grub screws, then slide and position the linear joiner so that it equally straddles both products. Tighten the grubs screws on one side first using a 2mm Allen key.

Then firmly hold the two V36P's together while tightening the last of the grub screws. There must be no gap between joining products.

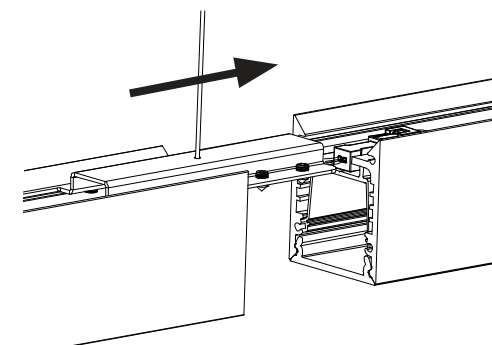

## REPAIR & REPLACEMENT

**VERY IMPORTANT! PLEASE READ BEFORE CARRYING OUT ANY WORK!**

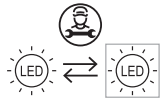

This product's light source is only replaceable by a qualified professional.

If the product has stopped working, please review the following before replacing the light source. It is important to identify why the product has stopped working first, as replacing the light source might not fix the cause of the failure.

When installed correctly, LEDs have a long service life, with light output gradually decreasing over time (L70 60k hrs, 70% light output after 60,000 hours of use).

Check the lighting circuit.

Was the correct power sourced used?  
Check product label for requirements.

Are there nearby heat sources that might overheat the product? See first page for maximum Ta and Tc details.

All work must be done by a qualified professional, and carried out in accordance with local regulations. All tools required to replace the light source are commonly found tools. Please contact LUMINO if further assistance is required.

It is the full responsibility of the professional carrying out the repair work to ensure that after the work is complete, the repaired product still complies with all relevant safety standards and is safe to use. LUMINO cannot accept liability for any harm resulting from an unsafe repair. If in any doubt, do not carry out repair work and contact LUMINO for support.

## TOOLS & PARTS LIST

### Tools & Consumables Required

- Isopropyl alcohol
- Flat head & T8 torx screwdriver
- 2.5mm Allen key
- Scissors
- Small hole punch tool (Ø1.2mm)
- Soldering iron
- Solder wick / sucker
- Solder (lead-free)
- Wire cutters

### Spare Parts

The following spare parts are available to order. Please contact LUMINO if any spare parts are required.

### LED Tape

EQ / ColorCORE / WarmDIM / RGBW / RGB

### Diffusers

V36P OPX diffuser  
V36P PRISMA diffuser  
V36P Diffusion film

### End Caps

V36P End cap - Silver / White / Black  
V36P End cap gasket

### Cables

V36P Clear PVC cable 2 core or 6 core  
V36P Cable cord grip  
V36P Drop wire 2m or 6m

These instructions explain the process for replacing the product's light source (LED tape) Do not attempt to repair while suspended. Only carry out repair work on a suitable workbench.

### 1. Turn off the power.

Turn off power to the LED power supply.

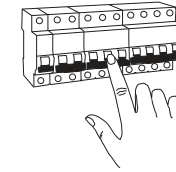

### 2. Disconnect V36P from LED driver.

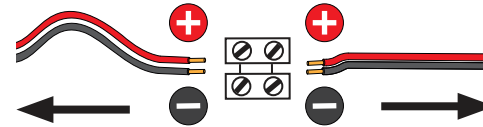

### 3. Release Cord Anchor

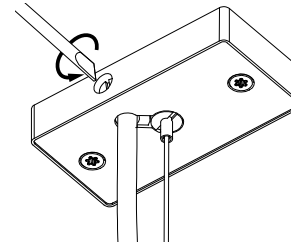

### 4. Release Drop Wire

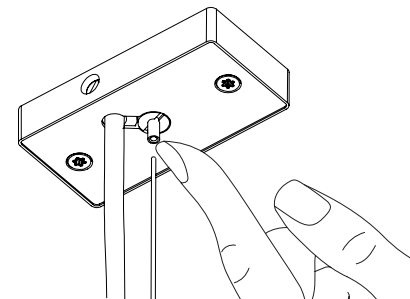

### 5. Check Product Label

See product label and check specification of LED tape inside. Replacement power output should match or be no greater than that of the original LED tape.

Product rear

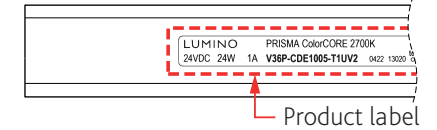

### 6. Move the Product

Move the V36P to an ESD safe workspace. Take all necessary ESD precautions where appropriate.



### 7. Release Cable Grip

Use a 2.5mm Allen key to release PVC cable.

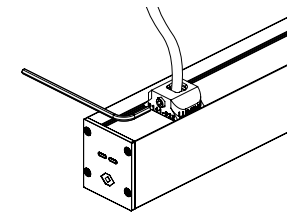

### 8. Remove End Caps & Gaskets

Carefully remove the end caps and gaskets from the V36P using a torx T8 bit.

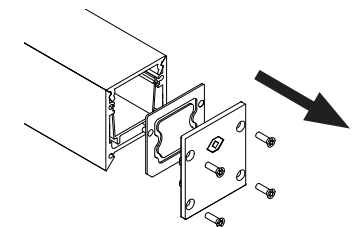

## 9. Remove Diffuser

Starting from one end, gently pry the plastic diffuser off from the V36P. Take care not to crack the diffuser. Extra attention is required for PRISMA as the cover is brittle. Set all components aside for later use.

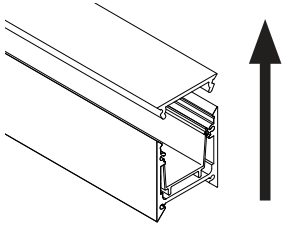

### [PRISMA] Remove Silicone

If fitted with a PRISMA cover, remove residual silicone from the aluminium profile and the PRISMA cover. Avoid using harsh chemicals. Soft plastic scraping tools recommended to avoid scratches in surface.

### [OPTIONAL] Remove Gear Tray

Carefully pry gear tray out of V36P profile for better access to cables. A long flat screw driver is recommended.

## 10. Unsolder Cable

Unsolder the individual wires from the LED tape. Additional solder and solder wick may be required to complete this step. Once the solder pad is at the correct temperature, slowly lift the LED tape away from the wires.

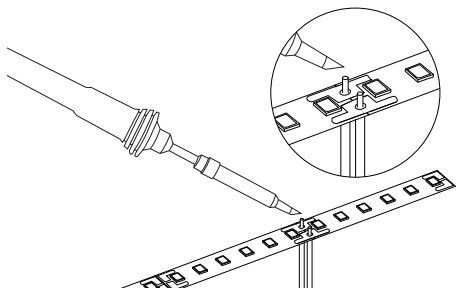

## 11. Remove LEDs

Remove the original LED tape. Lift one end of the LED tape and unpeel from the profile.

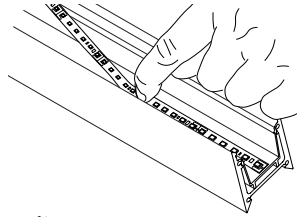

## 12. Recycling

Dispose of electronic waste in accordance with local environmental regulations. Do not send to landfill.



## 13. Clean

Remove any remaining adhesive residue inside the V36P profile. Use isopropyl alcohol if necessary and allow to air dry.

## 14. Measure LED Tape

Lay out the new LED tape, measuring how much is required. V36P profile's length should closely match the cut increments of the LED tape.

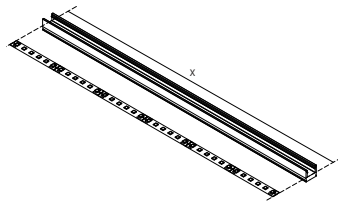

## 15. Trim LED Tape

Cut between the solder pads using strong scissors. LED tape cut increments are shown on the right.



## 16. Punch Holes

Using a small hole punch tool, create Ø1.2mm holes in the LED tape as shown.

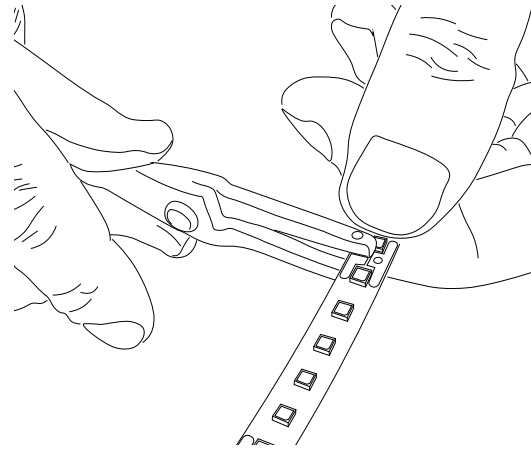

Hole position must match up with the cable entry hole on the V36P's profile. See hole offset set below.

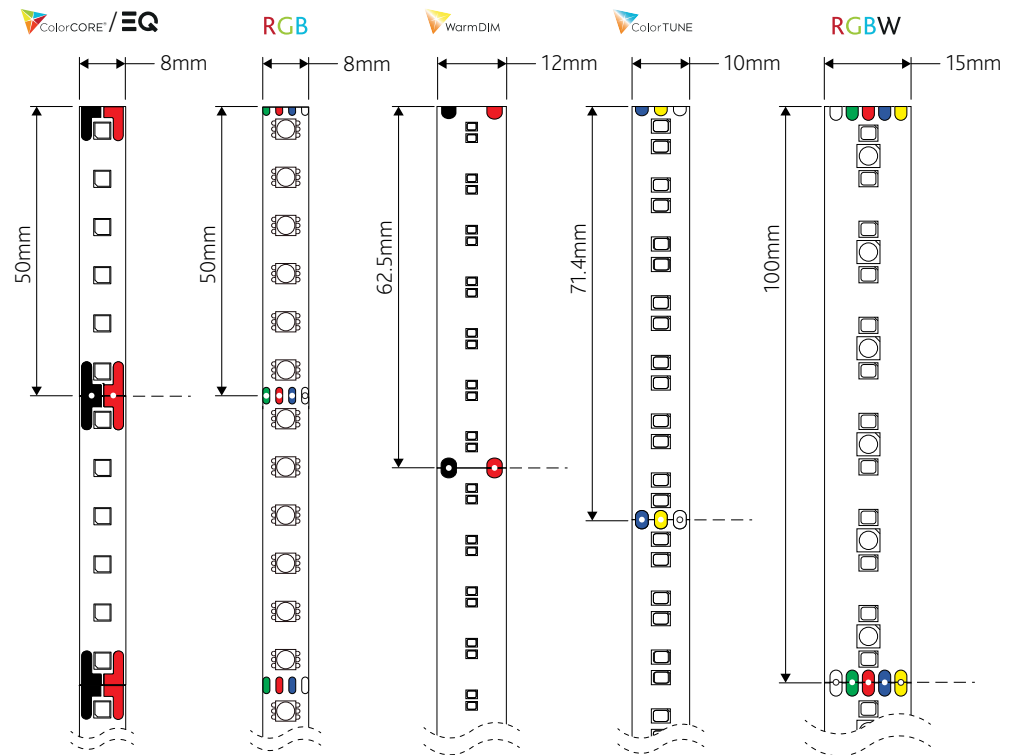
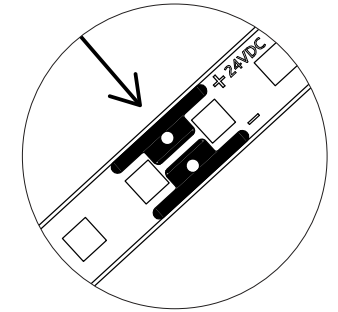



## 17. Solder Cables

With the paper backing on. Resolder the cable/s to the LED solder pads. Take care not to over heat the pads.  
**IMPORTANT:** Observe LED tape's polarities!

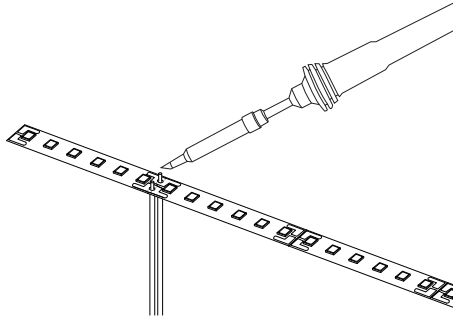

### Wiring Diagram

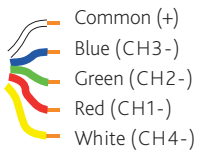

### [IF REMOVED] Replace Gear Tray

Align and centre the gear tray within the V36P profile and press down firmly using thumbs. Ensure any wires are not trapped/pinched.

## 18. Install LED Tape

Peel back 50mm to 100mm of the adhesive backing, starting with the hole punched end of the LED tape. Carefully align the beginning of the tape with the start of the V36S profile. Simultaneously unpeel backing and press down on the LED tape, working along the entire length of the profile.  
 Only use finger/thumb pressure on the LEDs.

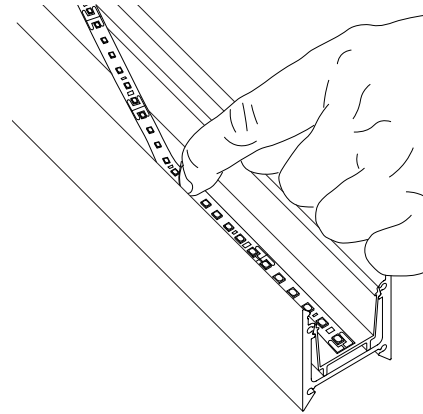

### [PRISMA] Silicone

Run a bead of clear silicone in the indicated channel. Centre and align, then snap in PRISMA cover. Install on one side in first as shown.

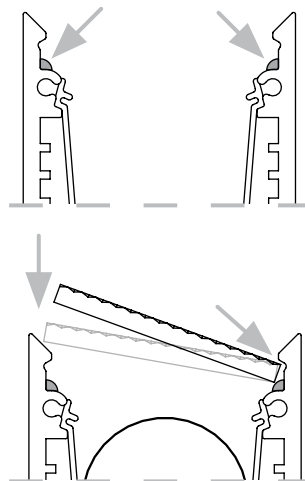

## 19. Test LED

Before any further work is done. Momentarily power the LED to verify that the cable was soldered to the LED tape correctly, and that the tape itself is functioning.

## 20. Install Diffuser

Align ends with the V36P extrusion, then snap the clear or opal diffuser cover into place with firm pressure applied from hands.

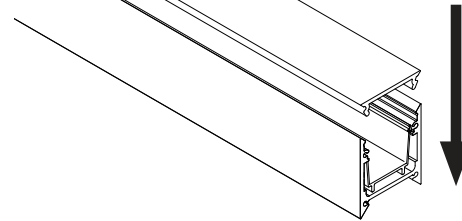

## 21. End Caps & Gaskets

Install both end caps with gaskets, using a torx T8 screwdriver.  
 Hand tighten screw, do not over torque.

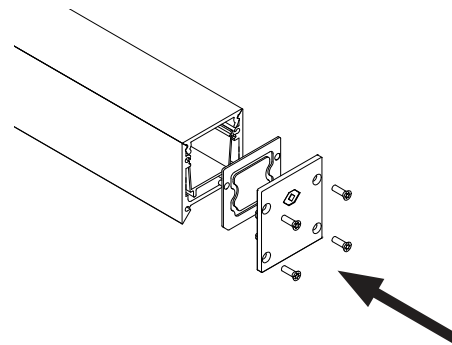

## 22. Reinstall Drop Wire

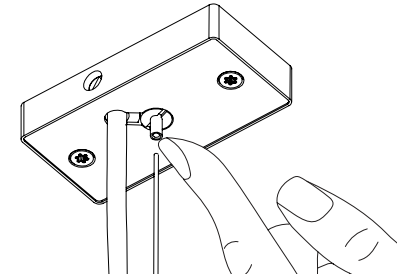

## 23. Tighten Cord Anchor

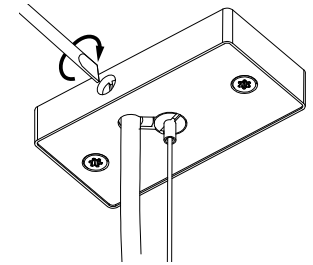

## 24. Reconnect V36P to LED driver.

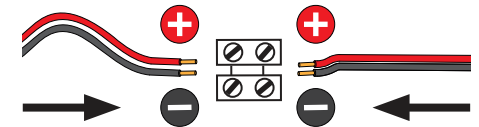

## 25. Power Up

Test the V36P. If the product does not function as expected, turn power off and inspect all connections.

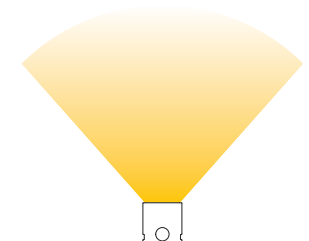

# LUMINO

## ECODESIGN REGULATION

This product is considered to be a “containing product” in the sense of Regulations (EU) 2019/2020 and (EU) 2019/2015.

The contained light source is replaceable only by a qualified professional.

This product contains a light source of energy efficiency class as shown in the Energy Rating table. Replacement light sources must be of equal or higher energy rating. Full electrical, mechanical, thermal and optical functionality must be restored by a qualified professional when light source is replaced.

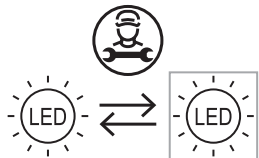

## DISMANTLING

Dismantling of light source from the containing product at end of life:

The product shall be disassembled in accordance to the provided instructions.

Containing products shall be separated from building material and/or from other additional mounting accessories by means of a professional installer.

Separate control gear and light sources must be disposed of at certified disposal companies in accordance with Directive 2012/19/EU (WEEE) in the EU and with Waste Electrical and Electronic Equipment (WEEE) Regulations 2013 in the UK.

LUMINO is a member of the WEEE producer compliance scheme.  
Registration number: WEE/MM8138AA

## ENERGY RATING

This product contains light sources of energy efficiency classes as shown:

LED	CCT	9.6W/m	12W/m	24W/m	30W/m
ColorCORE	4000K	-	F	F	F
	3500K	-	F	F	F
	3000K	-	F	F	F
	2700K	-	F	G	G
	2500K	-	F	G	G
	2200K	-	F	G	G
EQ	4000K	-	F	G	G
	3000K	-	G	G	G
	2700K	-	G	G	G
ColorTUNE	4000K - 2200K	-	-	F	-
	3000K - 1800K	-	-	F	-
WarmDIM	3000K	F	-	-	-
RGBW	RGB + 3000K	-	F	G	-
RGB	N/A				